

---

# THE HOLE NEWS

---

April

1996

---



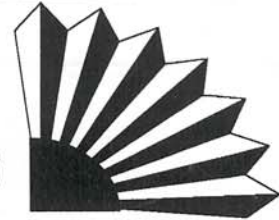
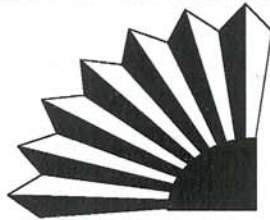

April 1996

Chartered 1984 as the 300th Grotto of the National Speleological Society

Volume 11 Number 14

THE MONTHLY PUBLICATION OF THE PERMIAN BASIN SPELEOLOGICAL SOCIETY

*"The Hole News"* is edited on 80486 25 MHz IBM personal computer utilizing Microsoft Publisher Version 2.0 desktop publishing program. The editor will accept modem transfer (14.4kb N81) or 5 1/4 and 3 1/2 floppy disks with \*.txt, .pub, .rtf, .doc, .wps, and .wri formats for trip reports and \*.bmp, .pcx, .tif, .pcd, .gif, .tga, .clp, .cut, .dib, .iff, .img, .jas, .jif, .jpg, .lhm, .mac, .msp, .pic, .rle, .wmf, .wpg, and .cdr formats for graphics. However typed or handwritten submissions as well as hand drawn graphics are also welcome. All are greatly appreciated. Contact the editor @ 915-559-3297 after 8 p.m.



**Read This. It Is Important:**

**Meeting change:** The next meeting of the PBSS will be Tuesday, April 9, in Andrews Texas at the Andrews Middle School. The school is located on third street between D and G avenues, see enclosed map. Meeting time will be about 7 pm. If everything goes right we should have a caving video to show.

If you want to eat supper in Andrews, most of us are going to Buddies, home of the best steakfingers in the world. Finger consumption should commence between 6 and 6:30 pm.

Until then, cave safely.

**Bug of the Month:**



*"The Hole News"* is the monthly publication of the Permian Basin Speleological Society. Articles and cartoons maybe reproduced by cave oriented publications that exchange newsletters with PBSS, as long as proper credit is given to the author. Items for this newsletter can be sent to the Chief Editor, *"The Hole News"*, c/o Walter Feaster 4307 Harvard Ave., Midland, Texas 79703-4847. Regular membership dues are only \$10.00 and includes one voting right, associate membership is \$ 5.00 and does not include a newsletter. Dues should be sent to PBSS Treasurer /Secretary c/o Walter Feaster, 4307 Harvard, Midland, Texas 79703. If you're interested in caving or even if you think you might like to try it, then contact Noel Pando at (915)-523-9294. Or if you are not from this area and some how through circumstances beyond you're control or ours found a copy of *"The Hole News"* then you should contact the National Speleological Society at 2813 Cave Avenue, Huntsville Alabama, 35810-4431.

\*\*\*\*\*On the Cover\*\*\*\*\*

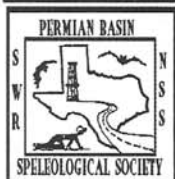

This is a drawing of a bat. Artist unknown. Acquired from the May 1995 issue of the "Pholeos" a journal of the Wittenberg University Speleological Society, Springfield, Ohio.

## Future Cave Trips: Also other events from PBSS and other grottos.

- April 5-7 SWR (Easter) Regional. At Freezeout Canyon (south of Hope, NM). Contact: Belski @ 505-885-6168.
- April 5-7 Restoration Trip to the Guads. Caves to be worked in are, Hidden, Black, and Cottonwood Cave. More info. contact Susan Herpin @ 713-939-7265.
- April 20-21 SWR GYPKAP Project. Vasco Bonita? Contact: S. Peerman @ 505-523-2167.
- April 20-21 Earth Day Project, Colorado Bend State Park. Contact Tom Kaler for info. @ (817)725-7583.
- April 27 TSS Technical Workshop. Contact: Bill Elliott @ (D) 512-475-8802 or (N) 512-835-2213, and E-Mail-welliott@utexas.edu .
- April 27-28 CACA Rebecca Lee has permits to Lake Cave and Corkscrew Cave in Carlsbad Caverns N.P. Contact Rebecca @ 915-695-0793. \*\*\*\*\*
- May 3-5 TSA Convention. Will be at the Lone Man II Ranch a few miles east of Wimberley, Texas. Contact: Dave McClung or Barbe Barker @ 214-594-1183.
- May 24-27 Caving at Camp Wood, TX. Fun caving, surveying, exploring, and more. Contact: Tom Kaler @ 817-725-7583, Pat Copeland @ 915-643-2952, or Mike Walsh @ 210-629-2169.
- May 25-27 SWR Memorial Day Regional. @ Pinon Cave (near Cloudcroft, NM) contact: Chris or Joli Lee @ 505-434-6604.
- May 24-27 Memorial Day. 0-9 Well If you are planning on going please contact Walter Feaster @ 915-559-3297, or write to- 4307 Harvard Ave, Midland, TX 79703-4847-71.
- June 15-16 Ken's Big cave adventure. Ken Kamon and some British cavers are going to Deep, Cottonwood, Gunsight, and Sentinel caves. Contact Ken @ 915-686-0720.
- June 17-22 CRF/NSS Carlsbad Caverns Restoration Field Camp. It cost \$50 for the week. Contact Mike Mansur @ 505-299-8283, or send your money to 8028 Bellamah NE, Albuquerque, NM 87110.
- August 3-9, 1996-NSS Convention, Salida, Colorado. NSS Convention Committee, c/o Skip Withrow, 5404 South Walden, St. Aurora, CO. 80015, (303)693-0997

Most all of this material was stolen from various and sometimes reliable caving newsletters in the Southwestern Region and surrounding area, including the TSA's "Activities Newsletter"

\*\*\*\*\* Denotes a PBSS club Trip...

Carlsbat Cavers, contact Phyllis Weston @ 505-887-6790 for restoration educational programs, off trail trips.

**IF YOU HAVE ANY CAVING TRIPS PLANNED, PLEASE LET THE EDITOR KNOW AND HE WILL PUBLISH THEM HERE IN THIS SPACE!.....**

### Ken's Big Cave Adventure:

A group of 12 British cavers will be flying into Midland, Texas on June 13 for a weekend of caving in the Guads.

If you are interested in helping out, or loaning camping / cooking gear, call Ken Kamon at (915)-686-0720.

They are planning on reserving the following caves:

- June 15-** Deep  
Cottonwood  
Gunsight
- June 16** Sentinel  
Cottonwood  
Gunsight

### Obituary

Charles Haskett of Houston, a fellow Texas caver and newsletter editor of the greater Houston grotto, passed away March 16. I meet him once and talked to him on the phone a few times and was looking forward to going caving with him. He will be missed by all.

### PBSS April Cave Trip

Lake and Corkscrew Caves are this months PBSS grotto trips. They are located in Slaughter Canyon, CACA National Park, NM. The date for this expedition is the weekend of April 27-28, 1996. The caves are permitted and openings are limited. Contact Rebecca Lee at the next meeting or call her at (915)695-0793.

### From the Secretary/Treasurer

Some time in the near future when you might be sitting around with nothing to do, how about sending me your 9 or 11 digite Zip-Code. This form of bureaucracy is suppose to speed up your mail delivery, at least the bills. Hopefully it will get your "Hole News" to you quicker. Thank you, Walter Feaster NSS#31624

### Texas and Mexico Cave Rescue

**Call Collect 210-686-0234**

This is Kriedler Funeral Home's 24 Hour number  
Ask for "Cave Rescue" and "John Kriedler"

**In New Mexico Dial 911**

---

**TRIP REPORTS:** and other lies and stories

---

**Signal Mountain Trip March 9, 1996**

**Cave:** Signal Mountain, Garrett Ranch, Howard County, Texas

**Explorers:** Doyle Phillips, Ruel Metcalf, Leslie and Nathan Clements, Ron Alton, and, Rebecca Lee.

The weather for this trip could not have been more perfect. The clear, blue sky called us upward as we climbed the steep, stone littered slope and the cool breeze pushed us along. Everyone climbed at a different pace. As we reached the top one or two at a time, we immediately began to explore in our different directions. The top is riddled with narrow but deep cracks. At first glance, the depths of these cracks seem impossible to chimney safely without belay. No one tried it. After watching Ron explore a crack on a lower level, I noticed the lower level continued to slope downward so I followed it. I soon found myself at what I was later told was the bottom. There was a hole that went even farther down and it had warm air with that limestone cave smell flowing from it. Ruel joined me at the bottom. We contemplated the hole and decided to go in was too dangerous. We were warned of rattlesnakes and that was on our minds. To get out, we chimneyed up a different crack and found ourselves coming out of one of the cracks that seemed impossible to chimney earlier.

Just as we had come up the mountain, we went down it. Some of the group decided to leave, but Doyle, Leslie, Nathan, Ruel, and I stayed and explored the other mountains in the area finding fossils and arrowheads along the way. Doyle found a hatchet shaped piece of flint obviously used by a native person for scraping and Nathan added it to his meteorite collection.

We did a lot of hiking and cave searching. We will go back again some day and maybe that will be the day we find the mother of all caves.

Submitted by Rebecca Lee NSS # 42075

---

**Inner Space Caverns**  
Texas ⇄

Again this is taken from the Corel Photos CD Rom. I needed to fill space again.

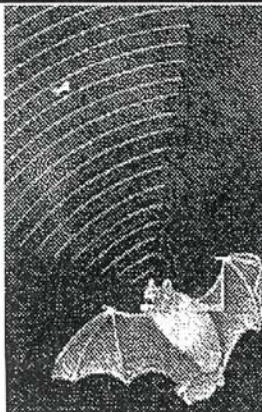

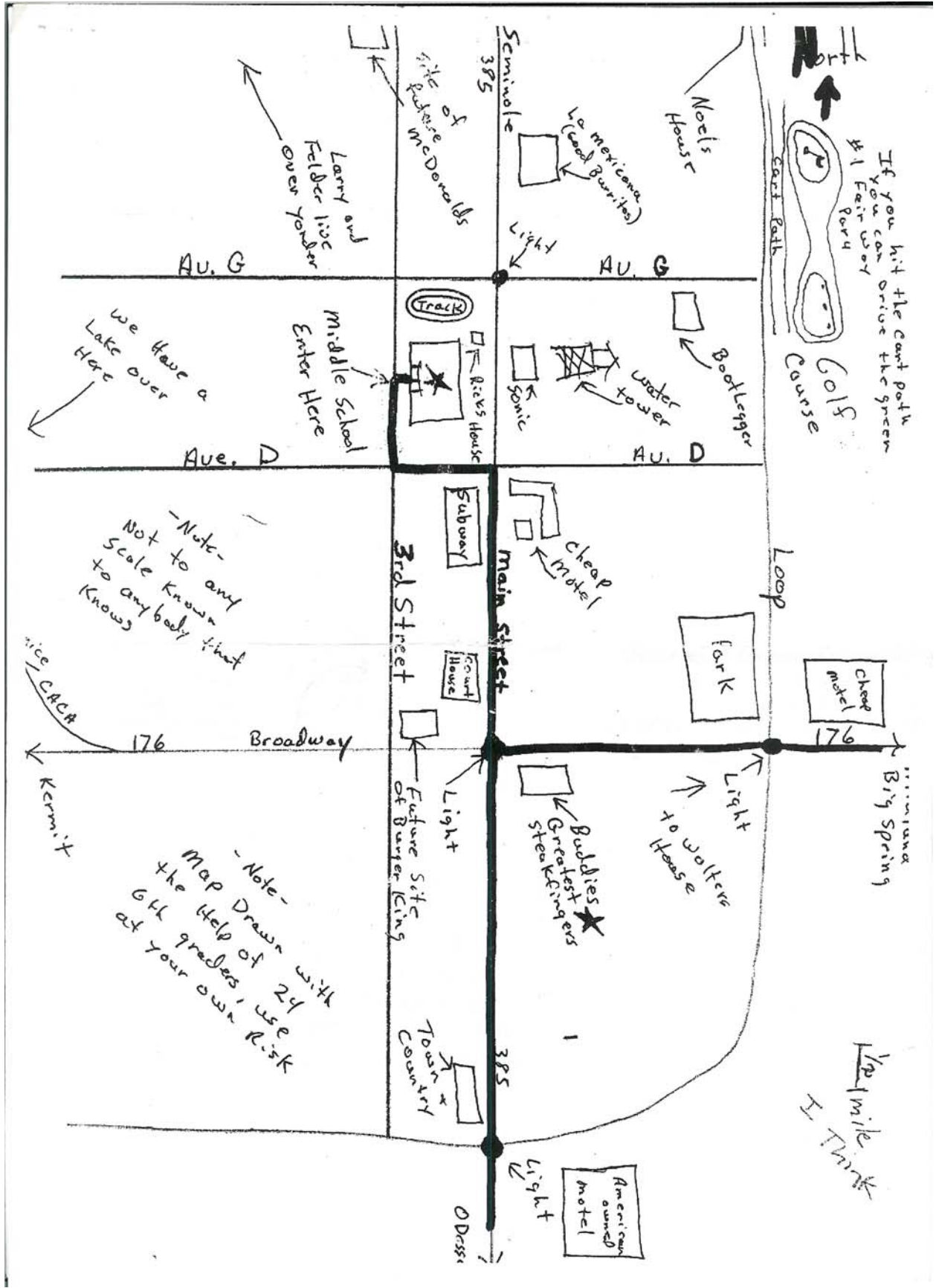

The Permian Basin Speleological Society  
c/o Walter Feaster  
4307 Harvard Ave.  
Midland, The Republic of Texas 79703 4847 71



**BILL BENTLEY & DONNIE**  
**400 EASTWOOD DR**  
**MIDLAND TX 79703 5308**

